

The Lantern Theatre Venue Information

The Lantern Theatre is an open plan, modular space, that can be used for a variety of different events, from theatrical performance to music evenings and mini conferences. Its current configuration is for theatrical performance, as this is the primary function of the venue. Because of the size of the space the level of intimacy is very refreshing and gives every audience member the feeling that they are right at the front.

The performance space is roughly 6.5 x 6.5 meters with two sets of curtains at the rear to enable crossovers. The lighting facilities at the lantern are limited due to the size of the space and are rigged at the front and sides of the space only, however this allows for a variety of states and colours. Our technician will also be on hand to make any slight adjustments, dependent on your needs. The space does have some high restrictions and would not support sets in excess 2.45 meters in high, we therefore strongly advise a viewing of the venue before you book it for your performance.

The back stage and dressing room area is relatively compact but can easily accommodate a cast of 10 - 15 but there may be queue for the mirror.

The Venue has a capacity of no more than 100 People, staff and cast members are included in this and should be factored into the production. the configuration of seating that you currently see in the plan has the capacity for an audience of 75, an extra row of seats at the front would give a capacity of 87, compromising the performance space to around a meter in depth and the amount of cast.

The Lantern Theatre has a fully licensed bar serving drinks, snacks and ice cream before, during the interval and after the performances. The bar will be staffed by employees of the lantern theatre at all times and can also be used as the box office for members of the public, who wish to purchase their tickets on the day of the performance. Audience members are advised to arrive 15 - 30 minutes before the event begins

In the event of a fire the staff members have been trained to assist the safe and orderly egress from the building through the exits shown on the plan by the red arrows

There is a goods lift at the rear of the building, use must be staff assisted.

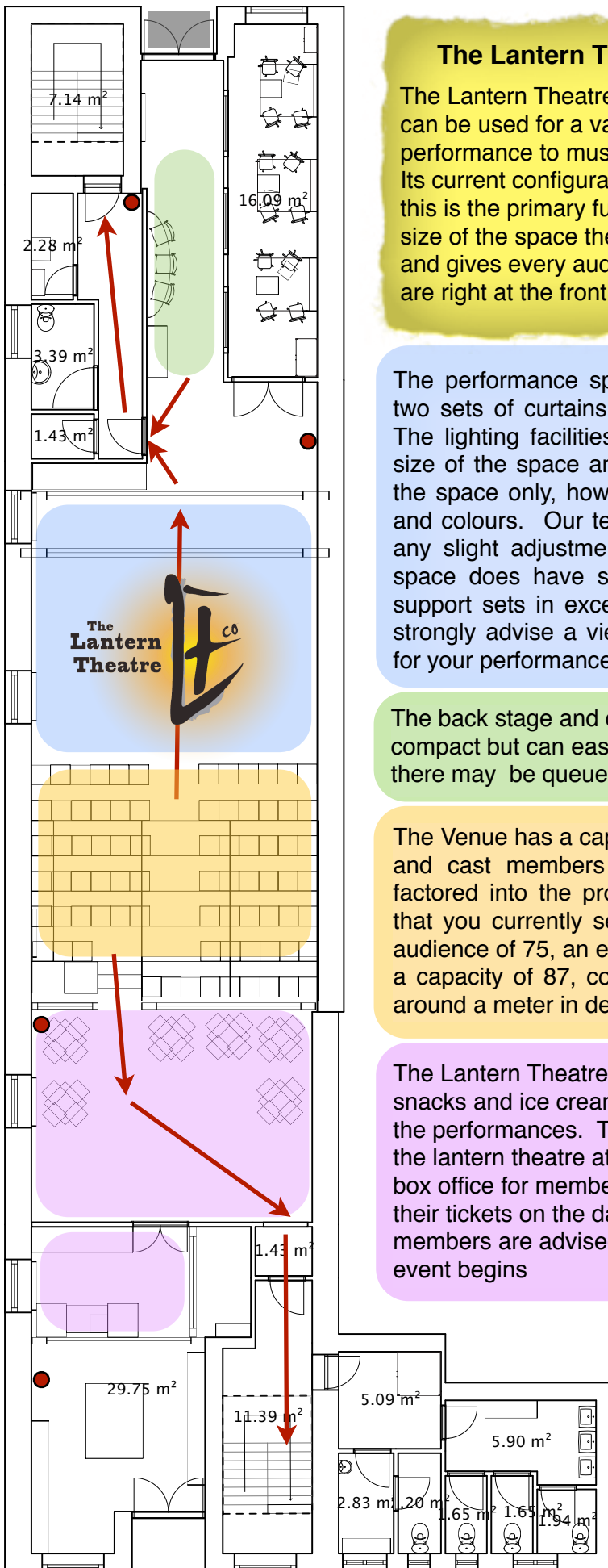



Technical Information

The Lantern Theatre has a warm, intimate and friendly atmosphere with a small control area at the rear left hand side of the audience which is not enclosed.

Stage Dimensions

Total Stage Area - 42m (6.5 x 6.5)
Working Depth - 4m (80 audience) - 6.5m (70 audience, no crossover)
Working Height - 2.4m
Working Width - 6.5m

Control Area

Lighting

Control Desk - Euro Light LC 2412
3 x 12 2.5kW Dimmers
Control of Smoke Machine
Control of House Lights

Sound

A full sound system is provided and designed for each hire. This can be discussed with the technical staff before the event.

2 x Peavy 4670 Speakers
2 x Foldback Speakers
2 x Sony Mini Disc
2 x CD Player

Additional Equipment

1 x Shure Drum Mics Set
6 x Shure SM58 Mics
6 x Shure SM57 Mic
Various Stands

Speakers are hung at the rear of the performance space but can be moved if required.



The position and colour of some lights can be moved by our technician, however this must be discussed and arranged in advance of the performance. Lighting sockets are as shown but again can be moved to other positions around the stage.

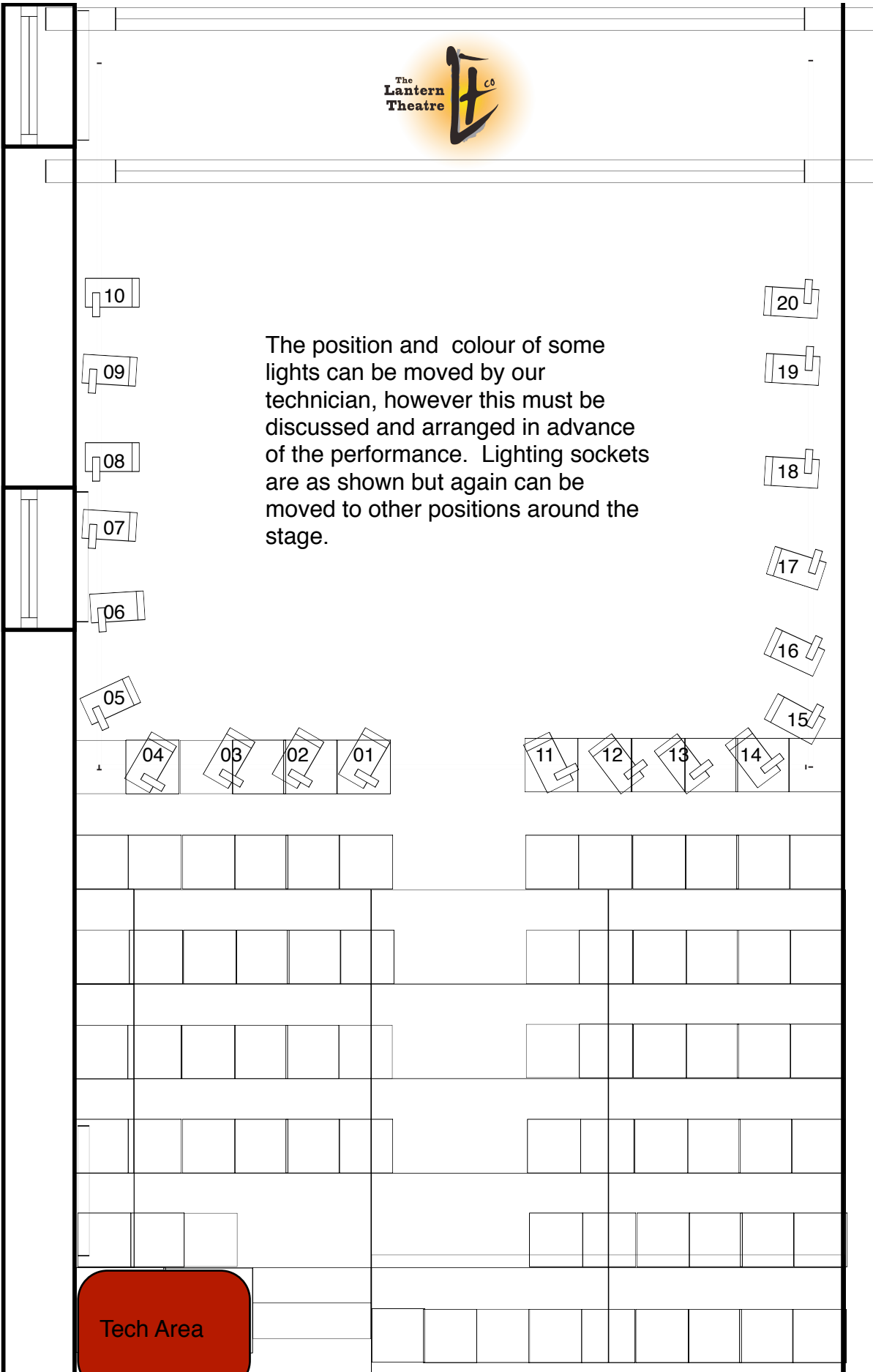

Tech Area



Performance Space @ The Lantern

Venue Hire Costs

The Lantern welcomes all local theatre groups, writers and performers to perform on our stage. Hourly Performance Hire Cost - £57 + Vat (*Most performances require 2 - 3 hours hire, please include get in and get out as our staff will still have to be in the venue*)

Cost includes

- Lighting & sound engineer for your performance
- Lantern Theatre staff for your event
- Fully licensed bar that will be open for the duration of the event
- Free rehearsal space for the first date of your event

Other Services Included

- On-line Bookings via The Lantern Theatre Website
- Box Office Management @ The Lantern Theatre
- Event information on website
- Event advertised in all local free listings
- Small article in our monthly newsletter
- Listed in our events guide outside the venue

Extra Costs

- Technician £15 per hour for tech rehearsals.
- Rehearsal Space £40 per day (10-4PM)
- Monday to Friday only (*Subject to availability*)

Please do not hesitate to call us if you require any further details.

Tel: 0151 703 0000